



UNITE CO

COMPACT GUIDE/BASH V2

Fitting Instructions

COMPACT GUIDE

Use the 3mm spacer behind the back plates for rough adjustment (if needed) and use the 3 x 1mm spacers (below) for finer adjustment for the perfect chain line

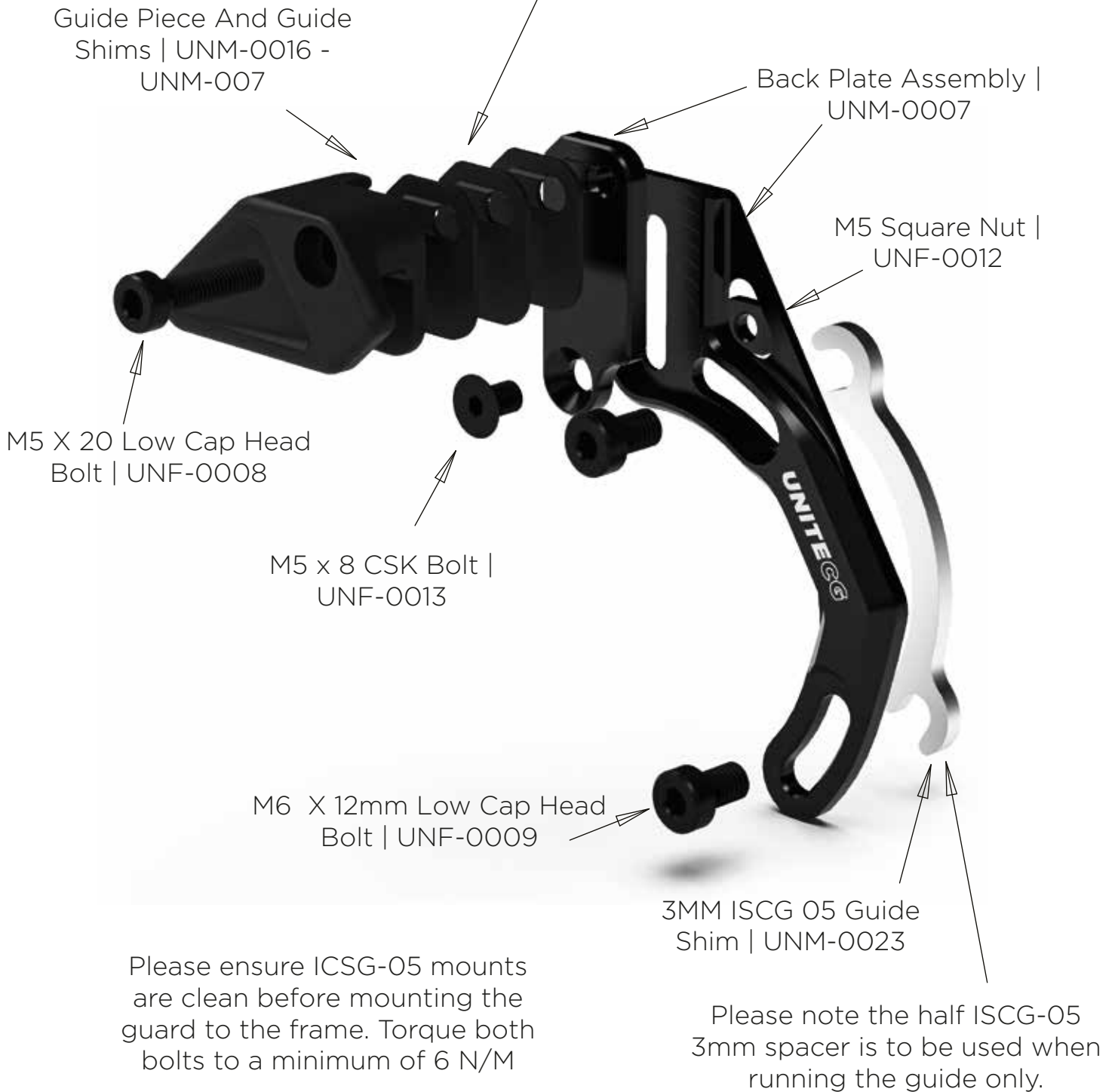

COMPACT BASH



Please ensure ICSG-05 mounts are clean before mounting the guard to the frame. Torque both bolts to a minimum of 6 N/M

COMPACT GUIDE AND BASH COMBINED

Use the 3mm spacer behind the back plates for rough adjustment (if needed) and use the 3 x 1mm spacers (below) for finer adjustment for the perfect chain line



Please note the full ISCG-05
3mm spacer is to be used
when running the guide and
the bash together

Some bikes with wide linkages or tight clearances
may need a combination of the 3mm spacer and
the 3 x 1mm spacers to ensure correct fitment.

COMPACT GUIDE

- 1 | Make sure bike is clean prior to installation.
- 2 | Put your bike in the lowest gear (smallest ring).
- 3 | Remove any device currently in the ISCG-05 tabs.
- 4 | Loosen/remove the slider assembly on the chain guide.
- 5 | Ensure the ISCG-05 tab threads are clean, Insert the 2 M6 x 12mm low cap head bolts a few turns with the guide to the top two ISCG05 holes, If needed (slide the 3mm guide shim spacer behind the guide)
- 6 | Adjust the guide so it sits just off the 12 o'clock position. then tighten to 8Nm
- 7 | Adjust the back plate assembly to fit your chain ring (approximately 3mm above the chain). remove or add 1mm spacers from the guide piece for finer adjustment.
- 8 | With the bike on a stand run through all of the gears ensuring the chain doesn't touch the slider assembly in any gear.

COMPACT BASH

- 1 | Make sure the bike is clean prior to installation.
- 2 | Remove any device currently in the ISCG-05 tabs.
- 3 | Ensure the ISCG-05 threads are clean.
- 4 | Get the Bash with the bash guard spacer and line it up to the ISCG-05 holes
- 5 | Insert the M6 x 18mm bolts.
- 6 | Then tighten both bolts to 8Nm

COMPACT GUIDE/BASH COMBINED

- 1 | Make sure the bike is clean prior to installation.
- 2 | Put your bike in the lowest gear (smallest ring).
- 3 | Remove any device currently in the ISCG-05 tabs.
- 4 | Loosen/remove the slider assembly on the chain guide.
- 5 | Ensure the ISCG-05 tab threads are clean, Insert the 2 M6 x 12mm low cap head bolts a few turns with the guide and bash to the top two ISCG-05 holes, If needed (slide the 3mm full ISCG-05 shim spacer behind the guide and bash)
- 6 | Add the M6 x 18mm CSK bolt into the bash.
- 7 | Adjust the guide so it sits just off the 12 o'clock position. Then tighten all three bolts to 8Nm
- 8 | Adjust the back plate assembly to fit your chain ring (approximately 3mm above the chain). remove or add 1mm spacers from the guide piece for finer adjustment.
- 9 | With the bike on a stand, run through all of the gears ensuring the chain doesn't touch the slider assembly in any gear.



 **UNITE**