

THM Tibia / Frontale Installation on D-Shaped Steerer Tubes with Support Wedge

The installation of the THM Tibia stem / THM Frontale combo bar must always be carried out according to the enclosed instructions. These additional instructions only apply to the installation on D-shaped steerer tubes with support wedge.

⚠ Warning

If not properly performed, assembly and maintenance work could cause accidents resulting in death or serious injury.

Do not overestimate your technical ability. All assembly and maintenance work should be performed by a specialist workshop for bicycles. This is the only way to ensure the work is conducted in a professional manner.

The end of the steerer tube must protrude from the clamping area of the stem by at least one millimeter and at most three millimeters, as described in the instructions. The support wedge must always sit flush with the upper edge of the clamping surface of the stem to ensure complete support of the stem.

The correct position of the support wedge and the steerer tube in relation to the stem can be seen in Figure 1. Figures 2 and 3 show examples of an incorrect position of the support wedge.

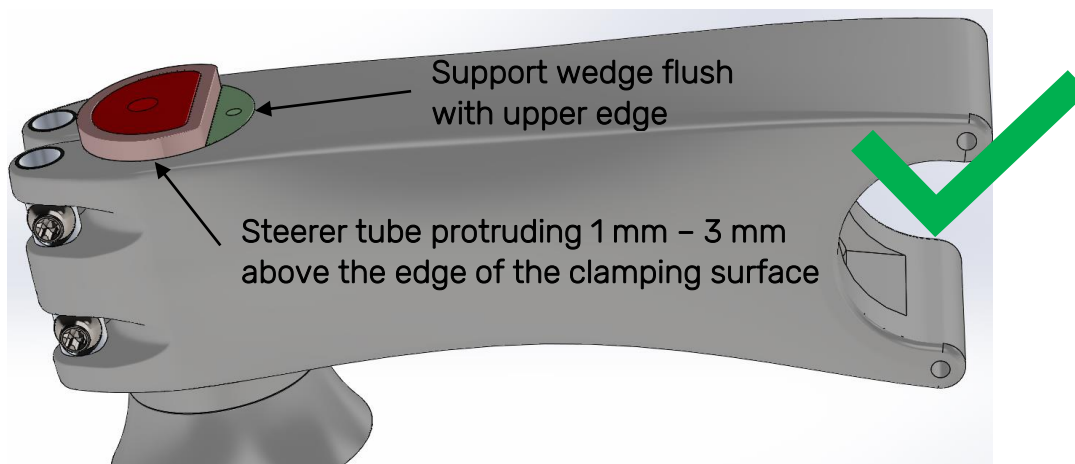

Fig. 1 Correctly installed wedge.

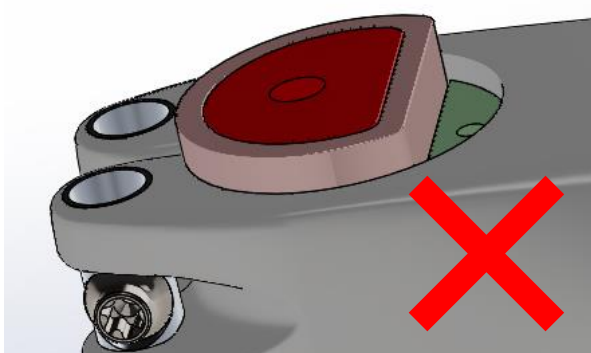

Fig. 2 Incorrectly installed wedge – the wedge has been pushed too far in.

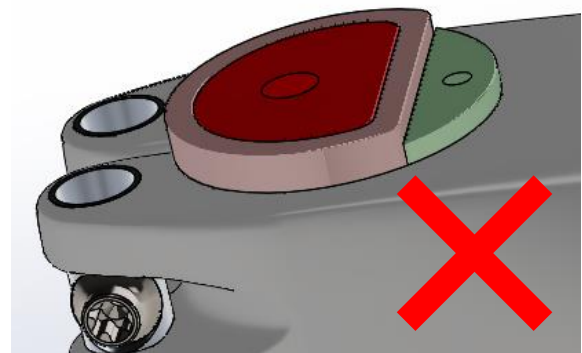

Fig. 3 Incorrectly installed wedge – the wedge has not been pushed in far enough.

THM Tibia / Frontale cable routing on D-Shaped Steerer Tubes

The THM Ulna Handlebars, Tibia Stem and Frontale combobar are prepared for internal cable routing on D-Shaped fork steerers in conjunction with hydraulic disc brakes and **electronic shifting only**.

There are $\varnothing 8$ mm holes in the handlebars near the locations of the brake levers, through which the brake lines are supposed to enter the handlebars. The exit point from the handlebars, where the lines transition into the stem is a $\varnothing 12$ mm hole in the transition surface between the handlebar and stem.

The brake lines can exit the stem either through the milled-out hole on the bottom of the stem (**THM Tibia only**, see Fig. 6), or through the molded hole inside the clamping surface of the stem (**THM Frontale only**, see Fig. 4 and Fig. 5).

It is advisable to start the routing process from the brake side of the line up through the frame and stem, before then routing the cables from the back through the handlebars and towards the brake levers. THM highly recommends using an internal cable routing kit, as this greatly simplifies the installation process, especially for the Frontale combobar where the handlebars and stem cannot be separated.

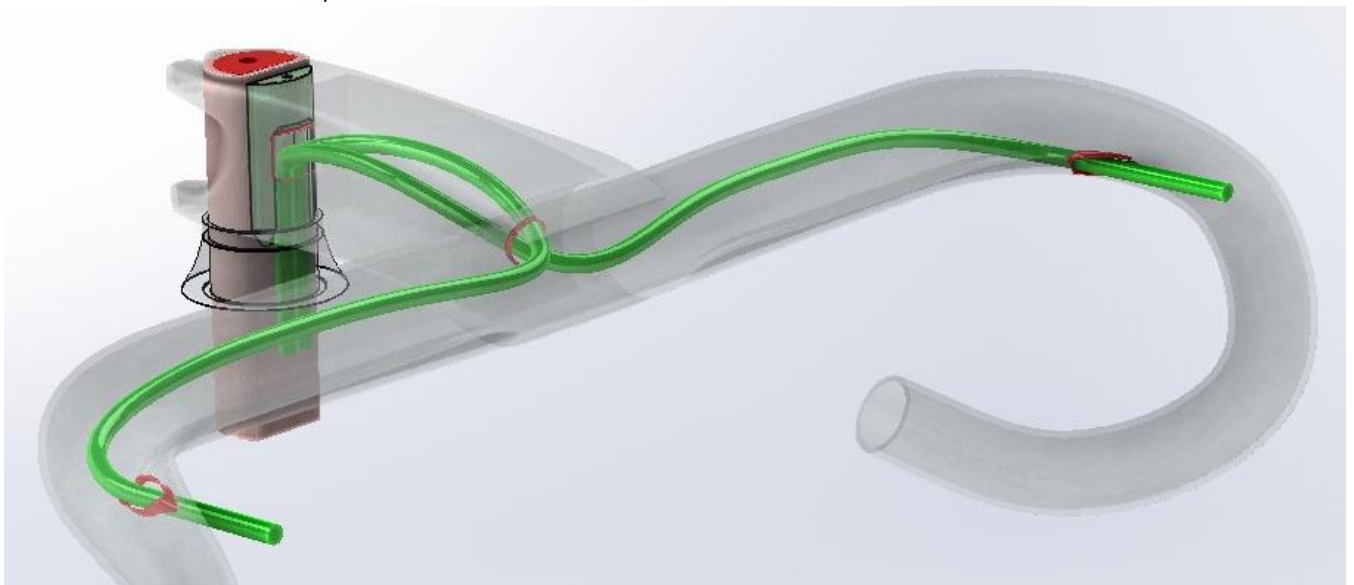

Fig. 4 Cable routing inside the THM Frontale combobar

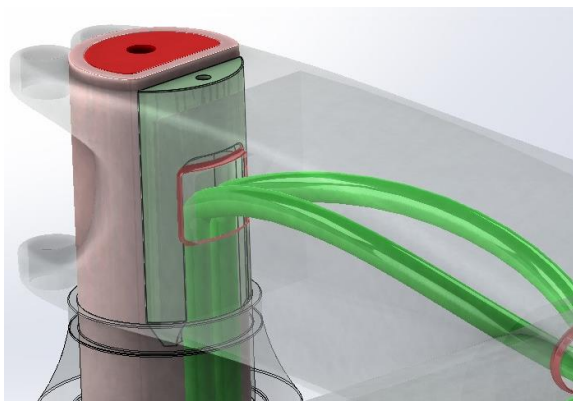

Fig. 5 Cable routing through the hole in the clamping surface of the THM Frontale

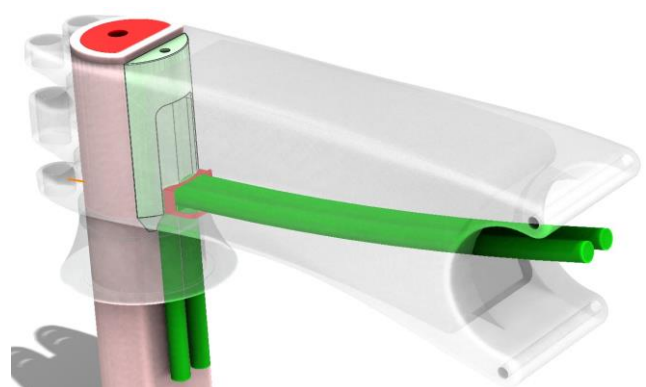

Fig. 6 Cable routing through the milled-out hole specific for D-shaped fork steerers; THM Tibia